

Palm Brace Kit



GripPle Palm Brace Kit provides an efficient solution for the protection of newly planted palms. Bracing Kits provide immediate day-one stabilization, allowing for proper root establishment.

FEATURES / BENEFITS

- Replaces unsightly traditional wooden staking methods.
- Eliminates time and labor associated with installing wooden stakes.
- Provided in a pre-assembled, lightweight kit for ease of transport.
- Can be used on a wide variety of species and sizes of palm trees.
- Engineered and specifiable solution provides consistent effective installation.
- GripPle fasteners allow for quick tensioning and, in the event of settlement, easy re-tensioning.
- Cable system provides minimal visible impediment to the surrounding landscape.
- Orange safety sleeves provide a visual barrier at ground level for pedestrians and landscaping crews.
- Easily removed after roots are establishment

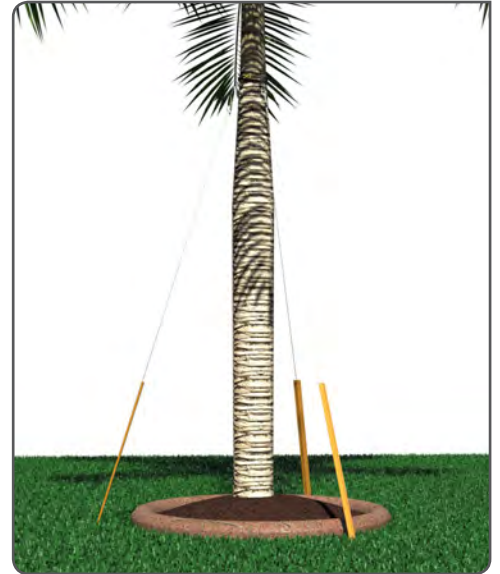

KIT CONTENTS



RECOMMENDED INSTALLATION TOOLS



Torq Tool



Gas Powered Driver (GPD)



Drive Rod



Wire Cutters

For more information contact us or visit our website - www.gripPle.com

INSTALLATION

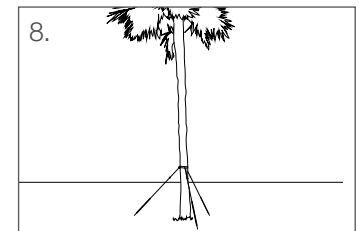
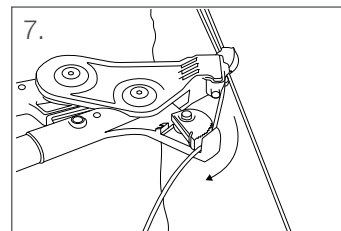
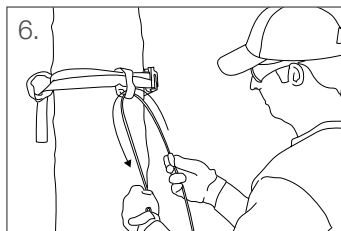
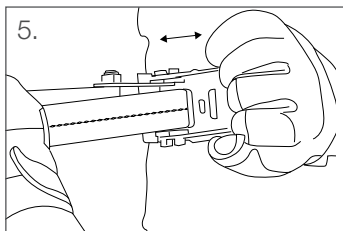
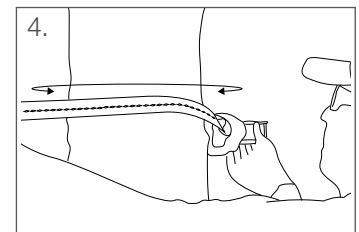
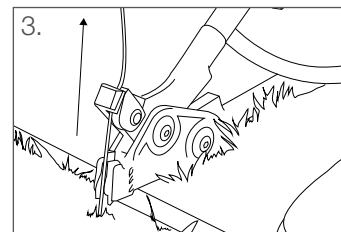
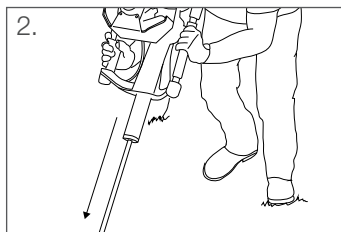
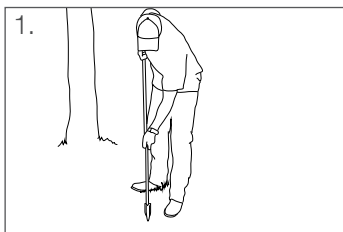

For more information on how to install the Palm Brace Kit visit our Youtube channel - GripPleTV. Alternatively see Installation Guidelines & Procedures.

PI-PBK-US-C

www.gripPle.com

GripPle's policy is one of continuous development and innovation. We therefore reserve the right to alter specifications, etc. without notice.

Proper considerations should be given to underground services before installing.

GripPle Inc | 1611 Emily Lane | Aurora, IL | 60502 USA
Tel 866 474 7753 Fax 800 654 0689 Email gripPleinc@gripPle.com

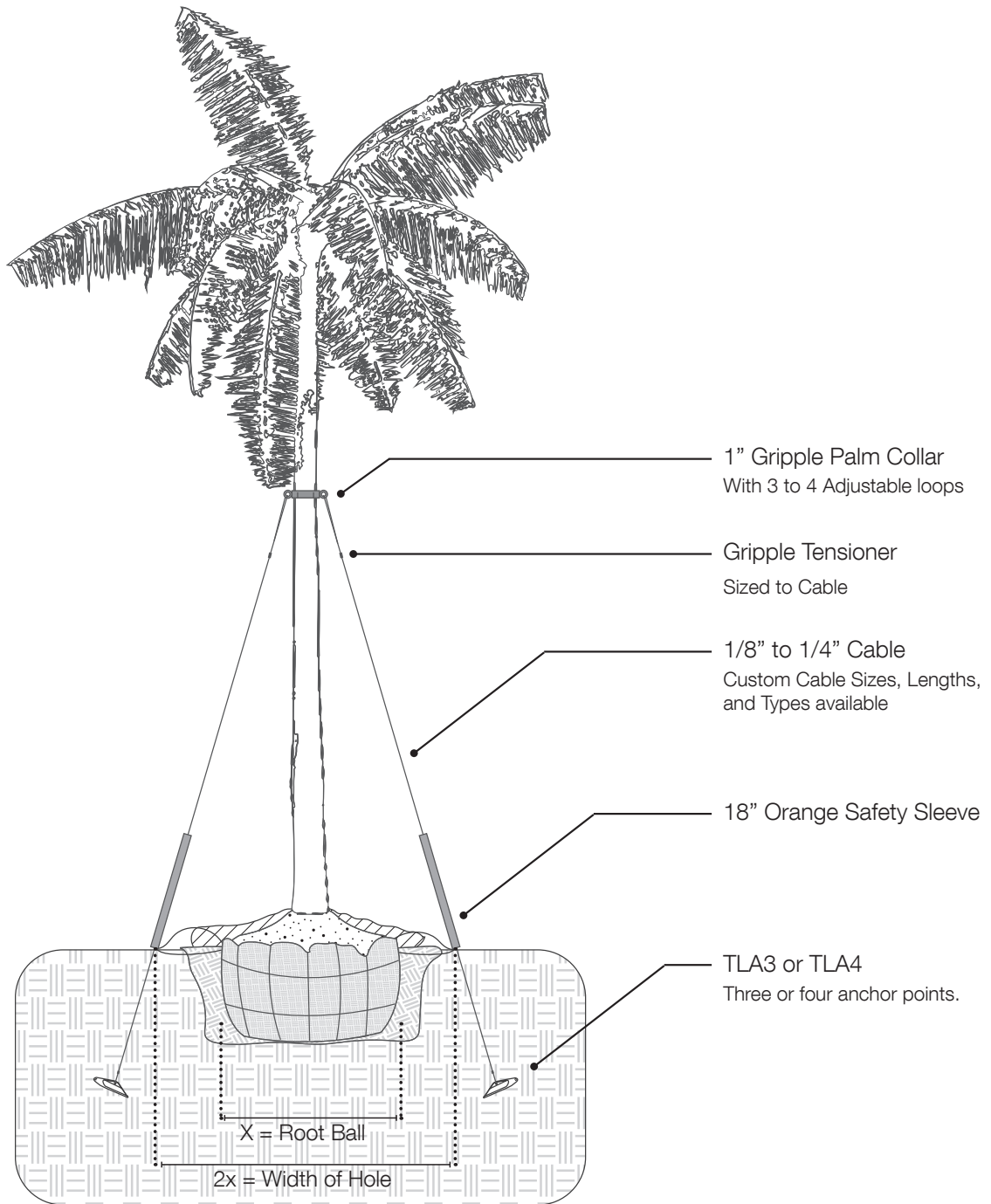

Product	Typical Trunk Caliper	Typical Tree Height	Anchor Size	Available Cable Size	Gripple Tensioner
PBK3	up to 10"	up to 30 FT	TLA3	1/8" or 5/32"	GPM or GPL
PBK4	up to 14"	up to 40 FT	TLA4	5/32" or 1/4"	GPL or D6